

- SITE PLAN KEYNOTES**
- EXISTING SECURITY FENCE.
 - EXISTING SLIDING SECURITY GATE.
 - EXISTING SECURE (SHERIFF'S) PARKING.
 - EXISTING PUBLIC AND STAFF PARKING (50 ASSIGNED SPACES).
 - PUBLIC ENTRANCE.
 - IN-CUSTODY TRANSPORT PATH OF TRAVEL.
 - LIMIT OF AREA OF WORK UNDER THIS PROJECT.
 - EXISTING SIDEWALK ("PUBLIC WAY").
 - ACCESSIBLE PATH OF TRAVEL TO PUBLIC WAY; MAX. SLOPE 5% IN DIRECTION OF TRAVEL; MAX. CROSS SLOPE 2% IN ANY DIRECTION.
 - RELOCATE EXISTING VAN-ACCESSIBLE PARKING TO COMPLY WITH ALL REQUIREMENTS OF **DETAIL 54/A.5**.
 - EXISTING ACCESSIBLE LANDING AT EXIT DOOR; NO PATH OF TRAVEL BEYOND SECURE AREA.
 - NEW ACCESSIBLE LANDING AND RAMP AT SALLY PORT DOOR; NO PATH OF TRAVEL BEYOND SECURE AREA.

SITE PLAN
SCALE : 1" = 40'

- ACCESSIBILITY NOTES**
- The path of travel (P.O.T.) as indicated is a barrier free accessible route at least 48 inches wide without any abrupt vertical changes exceeding 1/2" at 1:2 maximum slope, except that level changes do not exceed 1.4" vertical. Maximum cross-slope 2% typical and maximum slope in the direction of travel is 5% or less, unless otherwise noted. P.O.T. shall be maintained free of overhead obstructions to 80" minimum (CBC 1133B8.2) and side objects protruding greater than 4" into P.O.T. between 27 and 80 inches above the finished floor (CBC 1133B8.6).
 - Parking spaces assigned to Delano Division Court building; 50; number of accessible parking spaces provided: 2 (CBC 1129B.1).
 - All doors on indicated P.O.T.'s shall comply with applicable provisions of CBC 1133B, including:
 - The unlatching of any exit door shall not require more than one operation.
 - All exit doors shall be operable from the inside without the use of a key or any special knowledge.
 - Accessible door hardware shall be centered between 30 and 44 inches above the finish floor or landing, and shall be operated with single push-pull activating bars or other hardware designed to provide passage without requiring the ability to grasp the opening hardware.
 - Interior and exterior thresholds shall meet the level change limitations of item #1 above.
 - On doors that have closers the closer pressure shall not exceed 5 pounds for interior doors or 8.5 pounds for exterior doors.
 - The bottom 10 inches of all accessible doors shall have a smooth uninterrupted surface to allow the door to be opened by a wheelchair footrest.
 - Provide a level and clear landing on both sides of accessible doors, a minimum of 60" deep on the pull side and 48" deep on the push side, and extending a minimum of 18" beyond the latch jamb on the pull side of interior doors (24" at exterior doors), and a minimum of 12" beyond the latch jamb on the push side, unless the door is not equipped with a latch and closer.

- SIGNAGE GENERAL NOTES**
- All new signage shall comply with the provisions of CBC 1117B.5 for finish and contrast, proportions, character height, the use of raised characters/images, the application of Grade 2 Braille, and mounting location/height.
 - The height to the center of signs shall be 60" above the finish floor unless otherwise noted.
 - The international symbol of accessibility at the building entry may be a decal or vinyl image applied to the glass; all other signage for this work shall be wall-mounted plaques with raised characters/images and Braille dots as indicated in the Sign Schedule.
 - Bring any conflicts between the proposed location of a sign and other signage, electrical devices, etc., to the attention of the Architect for resolution prior to signage installation.

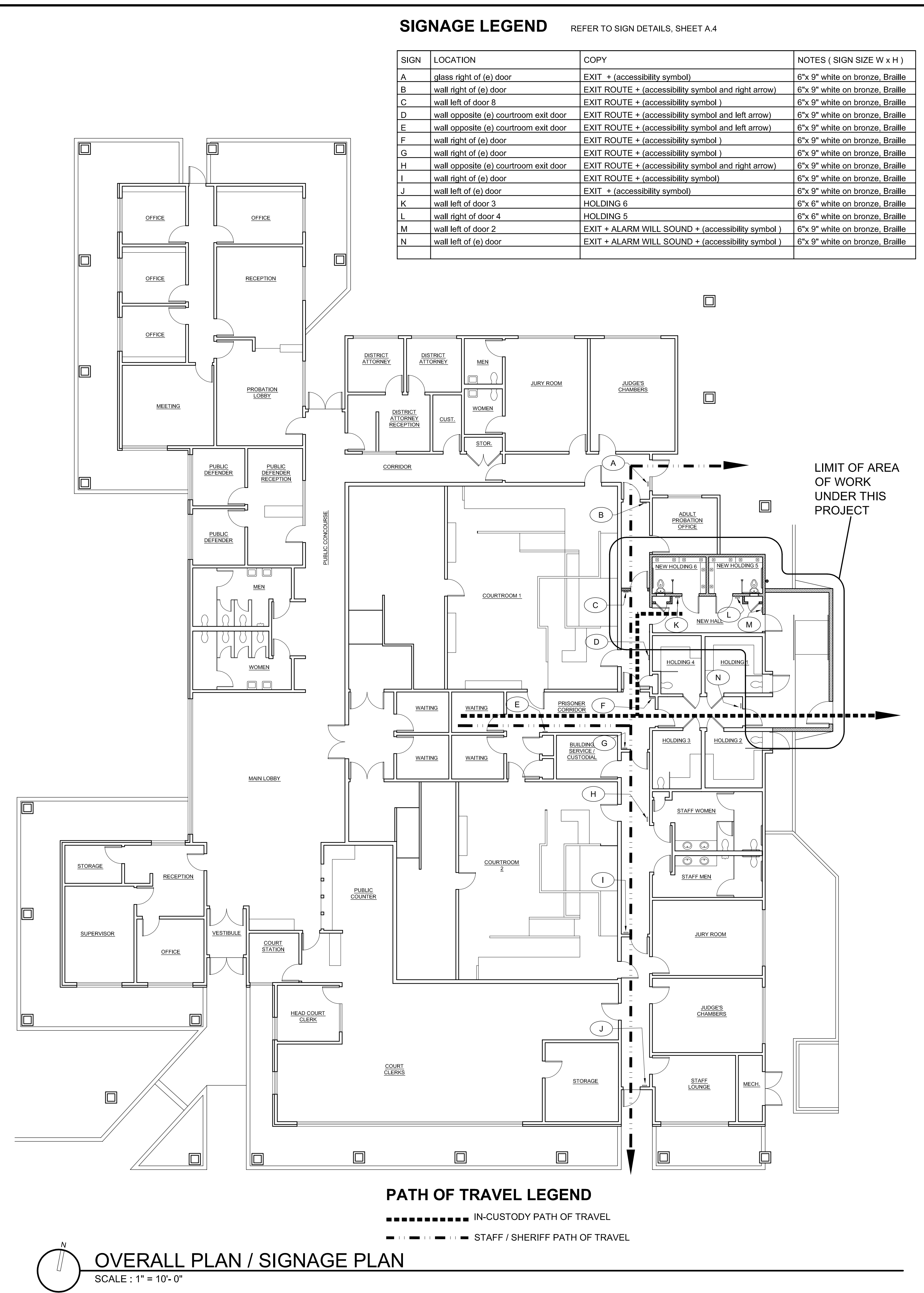

SIGNAGE LEGEND REFER TO SIGN DETAILS, SHEET A.4

SIGN	LOCATION	COPY	NOTES (SIGN SIZE W x H)
A	glass right of (e) door	EXIT + (accessibility symbol)	6"x 9" white on bronze, Braille
B	wall right of (e) door	EXIT ROUTE + (accessibility symbol and right arrow)	6"x 9" white on bronze, Braille
C	wall left of door 8	EXIT ROUTE + (accessibility symbol)	6"x 9" white on bronze, Braille
D	wall opposite (e) courtroom exit door	EXIT ROUTE + (accessibility symbol and left arrow)	6"x 9" white on bronze, Braille
E	wall opposite (e) courtroom exit door	EXIT ROUTE + (accessibility symbol and left arrow)	6"x 9" white on bronze, Braille
F	wall right of (e) door	EXIT ROUTE + (accessibility symbol)	6"x 9" white on bronze, Braille
G	wall right of (e) door	EXIT ROUTE + (accessibility symbol)	6"x 9" white on bronze, Braille
H	wall opposite (e) courtroom exit door	EXIT ROUTE + (accessibility symbol and right arrow)	6"x 9" white on bronze, Braille
I	wall right of (e) door	EXIT ROUTE + (accessibility symbol)	6"x 9" white on bronze, Braille
J	wall left of (e) door	EXIT + (accessibility symbol)	6"x 9" white on bronze, Braille
K	wall left of door 3	HOLDING 6	6"x 6" white on bronze, Braille
L	wall right of door 4	HOLDING 5	6"x 6" white on bronze, Braille
M	wall left of door 2	EXIT + ALARM WILL SOUND + (accessibility symbol)	6"x 9" white on bronze, Braille
N	wall left of (e) door	EXIT + ALARM WILL SOUND + (accessibility symbol)	6"x 9" white on bronze, Braille

- PATH OF TRAVEL LEGEND**
- IN-CUSTODY PATH OF TRAVEL
 - - - - - STAFF / SHERIFF PATH OF TRAVEL

OVERALL PLAN / SIGNAGE PLAN
SCALE : 1" = 10'- 0"

PROJECT
NEW HOLDING CELL PROJECT

DELANO / NORTH KERN COURT

1122 JEFFERSON ST. DELANO, CALIFORNIA

CLIENT JOB # 1027073 ARCHITECT JOB # 1002

FRASER SEIPLE ARCHITECTS

PROJECT MANAGER BDF

DRAWN BY BS

DATES 07-07-10
09-10-10
10-18-10 PLAN CHECK 1
11-23-10 PLAN CHECK 2
01-05-11 PLAN CHECK 3

SIGNED

The use of these plans and specifications shall be restricted to the original site for which they were prepared and publication thereof is expressly limited to such use. Reproduction or publication by any method, in whole or in part, is prohibited. Title to these plans and specifications remain with the architect without prejudice. Visual contact with these plans and specifications shall constitute prima facie evidence of the acceptance of these restrictions.

Written dimensions on these drawings shall have precedence over scaled dimensions. Contractors shall verify and be responsible for all dimensions and existing conditions on the job and shall report any discrepancies to the architect for resolution prior to commencing work.

SHEET TITLE
SITE, OVERALL PLAN

SHEET #
A.1