

CODE ANALYSIS
SCALE: 1/4" = 1'-0"

OCCUPANCY KEYNOTES

1. EXTENT OF CBC REQUIRED 2-HOUR VERTICAL BARRIER.
2. EXTENT OF CBC REQUIRED 1-HOUR VERTICAL BARRIER.
3. CBC REQUIRED 2-HOUR HORIZONTAL BARRIER AT ALL NEW "I" OCCUPANCY.
4. EXIT PATH OF TRAVEL FOR NEW "I" OCCUPANCY.

LEGEND

- EXISTING A-3 OCCUPANCY
- EXISTING B OCCUPANCY
- EXISTING I OCCUPANCY
- NEW I OCCUPANCY

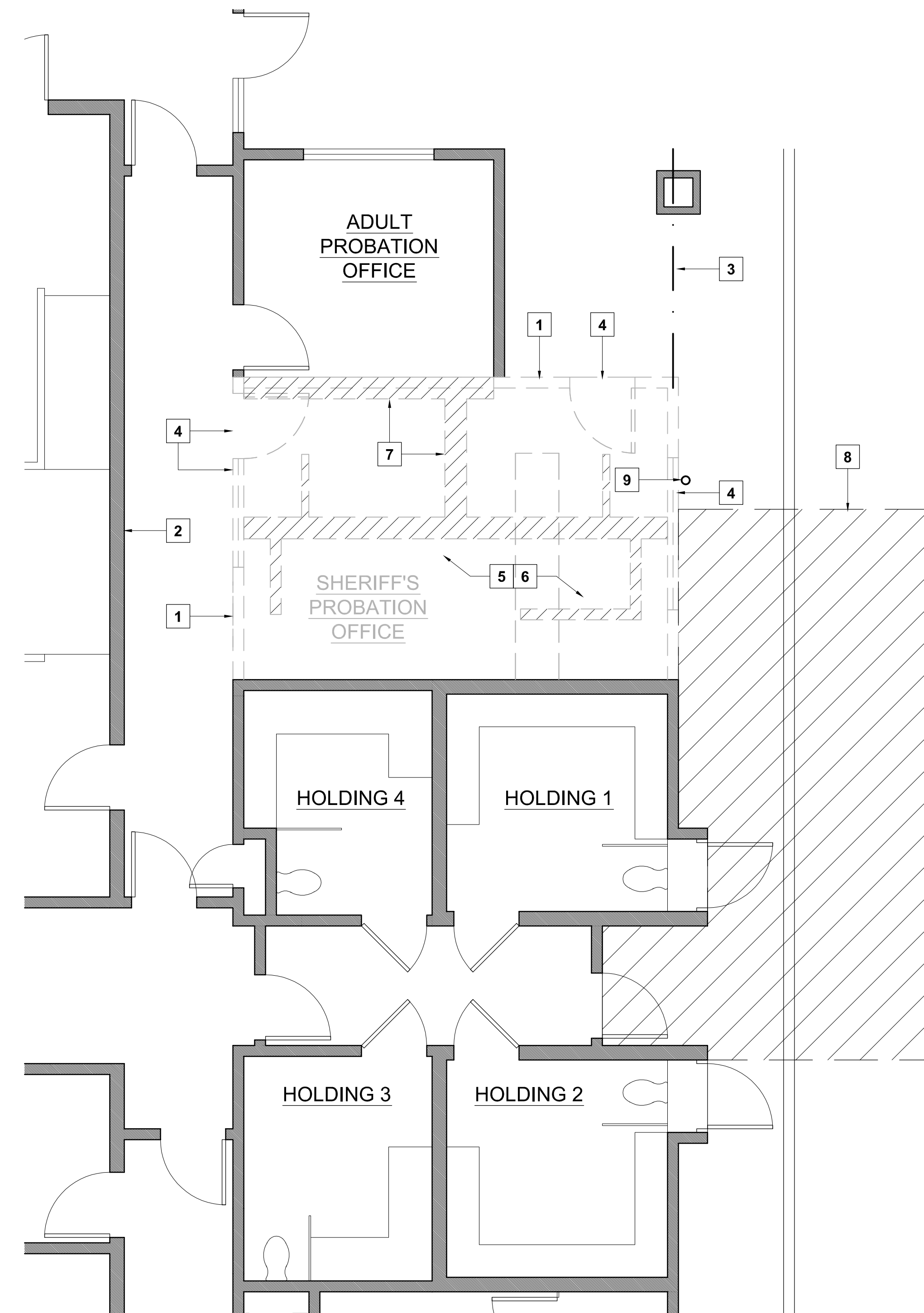

DEMOLITION PLAN
SCALE: 1/4" = 1'-0"

DEMOLITION KEYNOTES

1. EXISTING WOOD FRAMED WALL TO BE DEMOLISHED AND REMOVED FROM SITE; PULL WIRING AND OTHER INSTALLATIONS INTO ATTIC SPACE TO CLEAR NEW CONSTRUCTION.
2. GYPSUM BOARD TO BE REMOVED AT INTERSECTION OF NEW WALL.
3. EXISTING BEAM TO BE SHORED AND BRACED UNTIL ATTACHED TO NEW CONSTRUCTION.
4. DOORS, WINDOWS, AND FRAMES TO BE REMOVED AND DELIVERED TO KERN COUNTY AS DIRECTED.
5. ALL FLOORING FINISHES TO BE REMOVED FROM SITE.
6. ALL CEILING TILES AND LIGHT FIXTURES TO BE REMOVED AND DELIVERED TO KERN COUNTY AS DIRECTED. CEILING SUSPENSION SYSTEM AND GYPSUM BOARD CEILING SURFACES TO BE REMOVED FROM SITE.
7. FLOOR SLAB TO BE SAWCUT AT AREAS OF NEW FOOTINGS AND WASTE PLUMBING AND REMOVED. RECYCLE PER KERN COUNTY STANDARDS.
8. CONCRETE SIDEWALK AND CURB, AND ASPHALTIC CONCRETE PAVING TO BE SAWCUT AND REMOVED AS REQUIRED TO ACCOMMODATE NEW SALLYPORT. RECYCLE PER KERN COUNTY STANDARDS.
9. EXISTING FIRE SPRINKLER RISER AND ALARM ASSEMBLY TO BE RELOCATED. COORDINATE WITH COURTS, MONITORING AGENCY, AND FIRE SPRINKLER TO ASSURE MAXIMUM CONTINUITY OF SERVICE.

LEGEND

- EXISTING WALL TO REMAIN AND PROTECT
- EXISTING TO BE REMOVED

PROJECT

NEW HOLDING CELL PROJECT

DELANO / NORTH KERN COURT

1122 JEFFERSON ST.
DELANO, CALIFORNIA

CLIENT JOB # 1027073 ARCHITECT JOB # 1002



PROJECT MANAGER BDF

DRAWN BY BS

DATES 07-07-10
09-10-10
10-18-10 PLAN CHECK 1
11-23-10 PLAN CHECK 2
01-05-11 PLAN CHECK 3

SIGNED

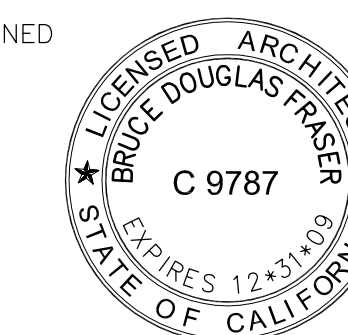

The use of these plans and specifications shall be restricted to the original site for which they were prepared and publication thereof is expressly limited to such use. Reproduction or publication by any method, in whole or in part, is prohibited. Title to these plans and specifications remain with the architect without prejudice. Visual contact with these plans and specifications shall constitute prima facie evidence of the acceptance of these restrictions.

Written dimensions on these drawings shall have precedence over scaled dimensions. Contractors shall verify and be responsible for all dimensions and existing conditions on the job and shall report any discrepancies to the architect for resolution prior to commencing work.

SHEET TITLE

**DEMOLITION PLAN,
CODE ANALYSIS**

SHEET #

A.2